

Tie Rod Standard Cylinder (ASC ASCD ASCJ Series)

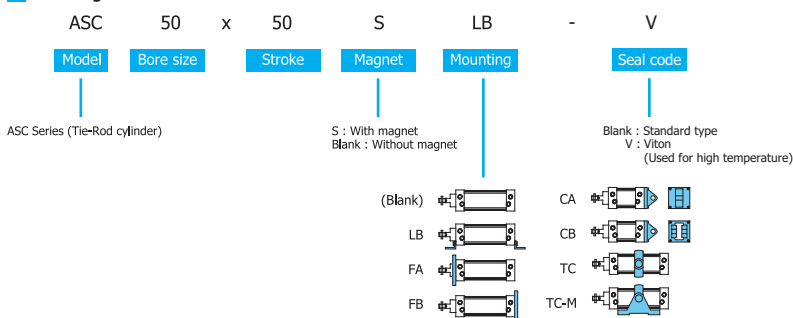

Ordering Code



Symbol

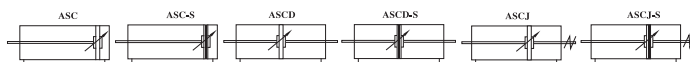

Specifications

Bore size	mm	32	40	50	63	80	100
Rod diameter	mm	12	16	20	20	25	25
Port size	inch	1/8	1/4	1/4	3/8	3/8	1/2
ASCD,ASCJ standard stroke	mm	25~200	25~200	25~200	25~200	25~300	25~300
ASC maximum stroke	mm	3000	3000	3000	3000	3000	3000
ASCD,ASCJ maximum stroke	mm	200	200	200	200	300	300
ASC available stroke up	mm	800	1000	1500	1500	1500	1500
ASCD,ASCJ available stroke up	mm	300	300	300	300	400	400
Adjustable cushion stroke	mm	24	24	24	24	32	32
ASCJ adjusting stroke	mm	25,50,75					
Action type		Double acting					
Media		Air					
Pressure range	kaf/cm ²	1.00~9.00					
Temperature range	°C	0 ~ 70 (Viton : 120)					
Speed range	mm/sec	50 ~ 800					
Magnet type		Without magnet (Blank),With magnet (S)					
Cushion type		Variable					
ASC mounting type		Basic (Blank),Foot (LB),Flange(FA FB),Clevis (CA CB CR),Trunnion (TC TC-M)					
ASCD,ASCJ mounting type		Basic (Blank),Foot (LB),Flange(FA),Trunnion (TC TC-M)					
End rod type		I knuckle (I), Y knuckle (Y), Floating joint(FJ),Universal joint(EJ)					
Sensor switch type		Light in front (CS1-F), Light on top (CS1-U)					
Sensor switch holder		SC32/40/50-SH		SC63-SH		SC80/100-SH	
Additional variants		Stainless steel piston rod, female, extended, special thread piston rod					

Other Available Series

Description	Ordering Code	Mounting type						
		LB	FA	FB	CA	CB	TC	TC-M
 Double rod cylinder ASCD	ASCD - 50 x 50 - S - LB LB : Mounting type S : Magnet 50 : Stroke 50 : Bore size ASCD : Double rod series	●	●	×	×	×	●	●
 Adjustable stroke cylinder ASCJ	ASCJ - 50 x 50 - 25 - S - LB LB : Mounting type S : Magnet 25 : Adjusted stroke 50 : Stroke 50 : Bore size ASCJ : Adjustable stroke series	●	●	×	×	×	●	●

Profile Standard Cylinder (ASU ASUD ASUJ Series)



Ordering Code

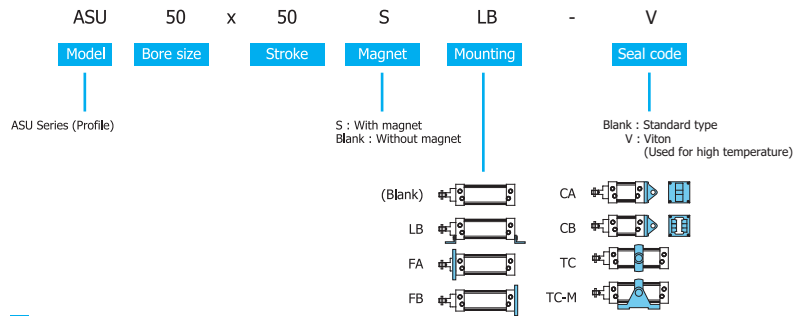

Symbol

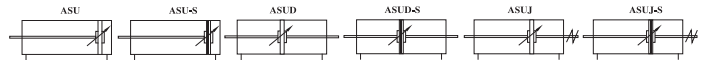

Specifications

Bore size	mm	32	40	50	63	80	100
Rod diameter	mm	12	16	20	20	25	25
Port size	inch	1/8	1/4	1/4	3/8	3/8	1/2
ASUD,ASUJ standard stroke	mm	25~200	25~200	25~200	25~200	25~300	25~300
ASU maximum stroke	mm	3000	3000	3000	3000	3000	3000
ASUD,ASUJ maximum stroke	mm	200	200	200	200	300	300
ASU available stroke up	mm	800	1000	1500	1500	1500	1500
ASUD,ASUJ available stroke up	mm	300	300	300	300	400	400
Adjustable cushion stroke	mm	24	24	24	24	32	32
ASUJ adjusting stroke	mm	25,50,75					
Action type		Double acting					
Media		Air					
Pressure range	kaf/cm ²	1.00~9.00					
Temperature range	°C	0 ~ 70 (Viton : 120)					
Speed range	mm/sec	50 ~ 800					
Magnet type		Without magnet (Blank),With magnet (S)					
Cushion type		Variable					
ASU mounting type		Basic (Blank),Foot (LB),Flange(FA FB),Clevis (CA CB CR),Trunnion (TC TC-M)					
ASUD,ASUJ mounting type		Basic (Blank),Foot (LB),Flange(FA),Trunnion (TC TC-M)					
End rod type		I knuckle (I), Y knuckle (Y), Floating joint(FJ),Universal joint(EJ)					
Sensor switch type		Light in front (CS1-F), Light on top (CS1-U)					
Sensor switch holder		SU32-SH	SU40-SH	SU50-SH	SU63-SH	SU80-SH	SU100-SH
Additional variants		Stainless steel piston rod, female, extended, special thread piston rod					

Other Available Series

Description	Ordering Code	Mounting type							
		LB	FA	FB	CA	CB	TC	TC-M-1	TC-M-2
<p>ASUD</p>	<p>ASUD - 50 x 50 - S - LB</p> <p>LB : Mounting type S : Magnet 50 : Stroke 50 : Bore size ASUD : Double rod series</p>	●	●	●	×	×	●	●	●
<p>ASUJ</p>	<p>ASUJ - 50 x 50 - 25 - S - LB</p> <p>LB : Mounting type S : Magnet 25 : Adjusted stroke 50 : Stroke 50 : Bore size ASUJ : Adjustable stroke series</p>	●	●	×	×	×	●	●	●

Dimensions

ASC & ASU

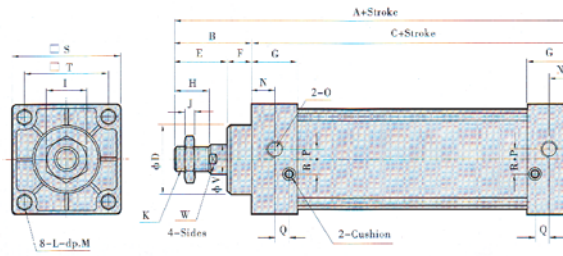

Item Bore size	A	B	C	D	E	F	G	H	I	J	K	L	M	N	O	P	Q	R	S	T	V	W
32	140	47	93	28	32	15	27.5	22	17	6	M10 x 1.25	M6 x 1	9.5	13.75	1/8"	3.5	7.5	7	45	33	12	10
40	142	49	93	32	34	15	27.5	24	17	7	M12 x 1.25	M6 x 1	9.5	13.5	1/4"	6	8.2	9	50	37	16	14
50	150	57	93	38	42	15	27.5	32	23	8	M16 x 1.5	M6 x 1	9.5	13.5	1/4"	8.5	8.2	9	62	47	20	17
63	153	57	96	38	42	15	27.5	32	23	8	M16 x 1.5	M8 x 1.25	9.5	13.5	3/8"	7	8.2	8.5	75	56	20	17
80	183	75	108	47	54	21	33	40	26	10	M20 x 1.5	M10 x 1.5	11.5	16.5	3/8"	10	9.5	14	94	70	25	22
100	189	75	114	47	54	21	33	40	26	10	M20 x 1.5	M10 x 1.5	11.5	16.5	1/2"	11	9.5	14	112	84	25	22

ASCD & ASUD

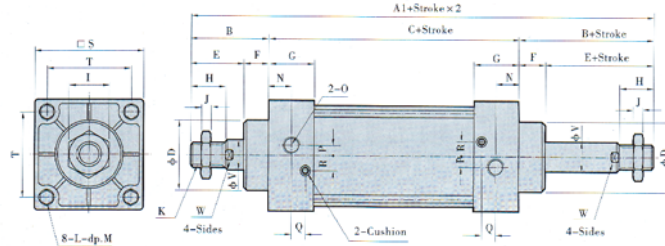

Item Bore size	A	B	C	D	E	F	G	H	I	J	K	L	M	N	O	P	Q	R	S	T	V	W
32	187	47	93	28	32	15	27.5	22	17	6	M10 x 1.25	M6 x 1	9.5	13.75	1/8"	3.5	7.5	7	45	33	12	10
40	191	49	93	32	34	15	27.5	24	17	7	M12 x 1.25	M6 x 1	9.5	13.5	1/4"	6	8.2	9	50	37	16	14
50	207	57	93	38	42	15	27.5	32	23	8	M16 x 1.5	M6 x 1	9.5	13.5	1/4"	8.5	8.2	9	62	47	20	17
63	210	57	96	38	42	15	27.5	32	23	8	M16 x 1.5	M8 x 1.25	9.5	13.5	3/8"	7	8.2	8.5	75	56	20	17
80	258	75	108	47	54	21	33	40	26	10	M20 x 1.5	M10 x 1.5	11.5	16.5	3/8"	10	9.5	14	94	70	25	22
100	264	75	114	47	54	21	33	40	26	10	M20 x 1.5	M10 x 1.5	11.5	16.5	1/2"	11	9.5	14	112	84	25	22

ASCJ & ASUJ

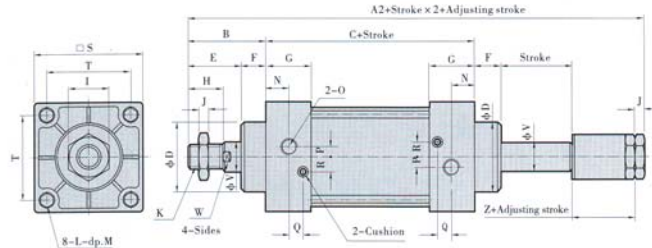

Item Bore size	A	B	C	D	E	F	G	H	I	J	K	L	M	N	O	P	Q	R	S	T	V	W	Z
32	182	47	93	28	32	15	27.5	22	17	6	M10 x 1.25	M6 x 1	9.5	13.75	1/8"	3.5	7.5	7	45	33	12	10	21
40	185	49	93	32	34	15	27.5	24	17	7	M12 x 1.25	M6 x 1	9.5	13.5	1/4"	6	8.2	9	50	37	16	14	21
50	196	57	93	38	42	15	27.5	32	23	8	M16 x 1.5	M6 x 1	9.5	13.5	1/4"	8.5	8.2	9	62	47	20	17	23
63	199	57	96	38	42	15	27.5	32	23	8	M16 x 1.5	M8 x 1.25	9.5	13.5	3/8"	7	8.2	8.5	75	56	20	17	23
80	243	75	108	47	54	21	33	40	26	10	M20 x 1.5	M10 x 1.5	11.5	16.5	3/8"	10	9.5	14	94	70	25	22	29
100	249	75	114	47	54	21	33	40	26	10	M20 x 1.5	M10 x 1.5	11.5	16.5	1/2"	11	9.5	14	112	84	25	22	29

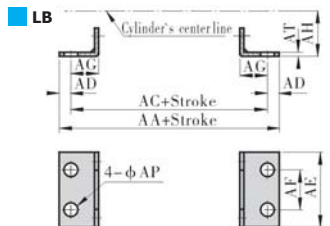

Bore size Item	32	40	50	63	80	100
AA	153	169	173	184	189	209
AC	134	140	149	158	168	174
AD	9.5	14.5	12	13	16	18
AE	50	57	68	80	97	112
AF	33	36	47	56	70	84
AG	20.5	23.5	28	31	30	30
AH	28	30	36.5	41	49	57
AP	9	12	12	12	14	14
AT	3	3	3	3	4	4

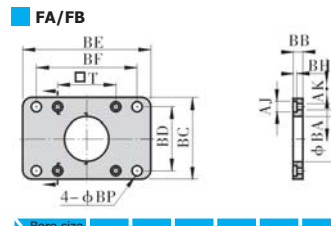

Bore size Item	32	40	50	63	80	100
AJ	10.5	10.5	10.5	13.5	16.5	16.5
AK	6.5	6.5	6.5	8.5	10.5	10.5
BA	28.3	32.3	38.3	38.3	47.3	47.3
BB	10	10	10	12	16	16
BC	50	55	68	78	100	120
BD	33	36	47	56	70	84
BE	80	90	108	120	143	162
BF	58	70	86	98	119	138
BH	6.5	6.5	6.5	8.5	10.5	10.5
BP	7	7	9	9	11	11
T	33	37	47	56	70	84

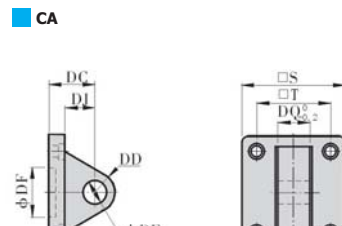

Bore size Item	32	40	50	63	80	100
S	48	50	62	75	94	112
T	33	37	47	56	70	84
DC	34	34	34	34	48	48
DD	14	14	15	15	20	20
DE	12	14	14	14	20	20
DJ	14	14	15	15	20	20
DQ	16	20	20	20	32	32

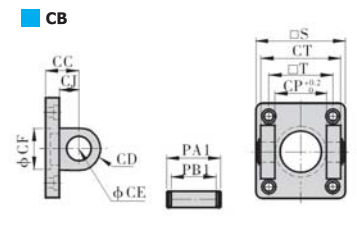

Bore size Item	32	40	50	63	80	100
CC	19	19	19	19	32	32
CE	12	14	14	14	20	20
CJ	13	13	15	15	21	21
CP	16.3	20.3	20.3	20.3	32.3	32.3
CT	32	44	52	52	64	64
PA1	41	51.8	60.3	60.3	73.8	73.8
PB1	33.5	45.5	54	54	65.5	65.5
S	48	50	62	75	94	112
T	33	37	47	56	70	84

Y Knuckle

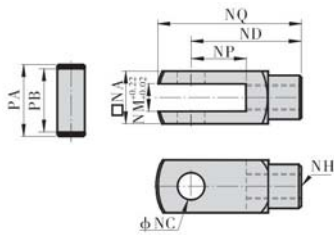

Bore size \ Item	NA	NC	ND	NE	NF	NG	NH	NM	NP	NQ	PA	PB
32	19	10	40	52	15	20	M10 x 1.25	10	20	52	26.2	20
40	25.4	12	48	67	24	20	M10 x 1.25	12	24	62	32.8	26.5
50	31.7	16	64	89	32	23	M16 x1.5	16	32	80	39.3	33
63	31.7	16	64	89	32	23	M16 x1.5	16	32	80	39.3	33
80	44.4	20	80	105	40	30	M20 x1.5	20	40	105	53.3	45
100	44.4	20	80	105	40	30	M20 x1.5	20	40	105	53.3	45

I Knuckle

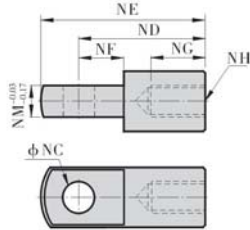

Bore size \ Item	NA	NC	ND	NE	NF	NG	NH	NM	NP	NQ	PA	PB
32	19	10	40	52	15	20	M10 x 1.25	10	20	52	26.2	20
40	25.4	12	48	67	24	20	M10 x 1.25	12	24	62	32.8	26.5
50	31.7	16	64	89	32	23	M16 x1.5	16	32	80	39.3	33
63	31.7	16	64	89	32	23	M16 x1.5	16	32	80	39.3	33
80	44.4	20	80	105	40	30	M20 x1.5	20	40	105	53.3	45
100	44.4	20	80	105	40	30	M20 x1.5	20	40	105	53.3	45

Floating Joint

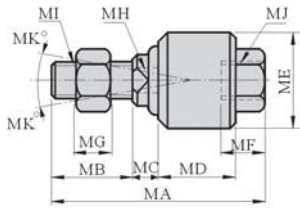

Bore size \ Item	MA	MB	MC	MD	ME	MF	MG	MH	MI	MJ	MK
32	58	22	7	21	26	11.5	7	10	M10 x 1.25	M10 x 1.25	12
40	58	22	8	21	28	11.5	8	12	M10 x 1.25	M10 x 1.25	12
50	90	27	10	41	44.5	20	10	17	M16 x1.5	M16 x1.5	7
63	90	27	10	41	44.5	20	10	17	M16 x1.5	M16 x1.5	7
80	102	29	13	46	53	24	13	22	M20 x1.5	M20 x1.5	10
100	102	29	13	46	53	24	13	22	M20 x1.5	M20 x1.5	10

Universal (Fish eye) Joint

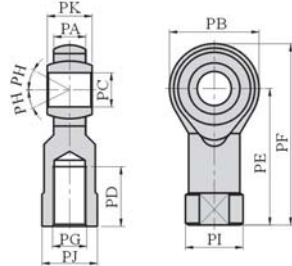

Bore size \ Item	PA	PB	PC	PD	PE	PF	PG	PH	PI	PJ	PK
32	11	26	10	20	43	56	M10 x 1.25	13	19	17	14
40	12	32	12	24	50	66	M10 x 1.25	13	22	19	16
50	15	40	16	28	64	84	M16 x1.5	15	27	22	21
63	15	40	16	28	64	84	M16 x1.5	15	27	22	21
80	18	46	20	35	77	100	M20 x1.5	15	34	30	25
100	18	46	20	35	77	100	M20 x1.5	15	34	30	25

TC for ASU

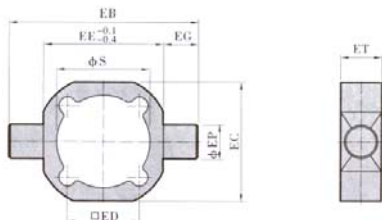

Bore size \ Item	EB	EC	ED	EE	EG	EP	ET	S				
40	113	63	37	63	25	25	30	45.5				
50	126	76	47	76	25	25	30	55.5				
63	138	88	56	88	25	25	30	68.5				
80	164	114	70	114	25	25	35	87.5				
100	182	132	84	132	25	25	40	107.5				

TC for ASC

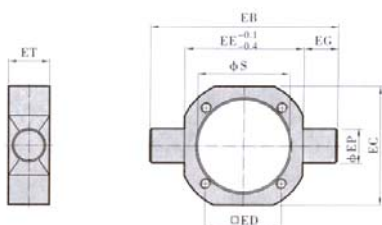

Bore size \ Item	EB	EC	ED	EE	EG	EP	ET	S				
40	113	63	37	63	25	25	30	45.5				
50	126	76	47	76	25	25	30	55.5				
63	138	88	56	88	25	25	30	68.5				
80	164	114	70	114	25	25	35	87.5				
100	182	132	84	132	25	25	40	107.5				