

ISO6430 Stainless Steel Slim Cylinder (MISA MITA Series)

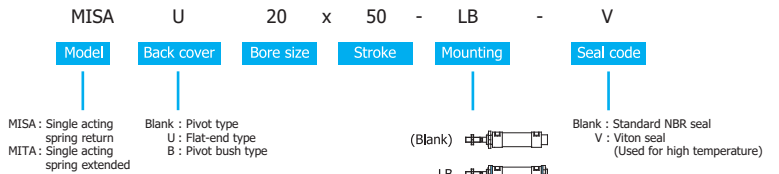

Ordering Code



Symbol

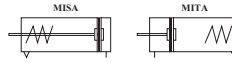

Specifications

Bore size	mm	20	25	32	40
Rod diameter	mm	8	10	12	16
Port size	inch	1/8	1/8	1/8	1/8
Standard stroke	mm	25~100	25~100	25~100	25~100
Maximum stroke	mm	100	100	100	100
Available stroke up	mm	150	150	150	150
Action type		Single acting			
Media		Air			
Pressure range	kgf/cm ²	2.00 ~ 9.00			
Temperature range	°C	0 ~ 70 (Viton : 120)			
Speed range	mm/sec	30 ~ 800			
Back cover type		Pivot (Blank) , Flat end (U) , Pivot bush (B)			
Cushion type		Bumper			
Mounting type		Basic (Blank),Foot (LB),Flange(FA),Pivot (SDB)			
End rod type		I knuckle (I), Y knuckle (Y), Floating joint(FJ),Universal joint(EJ)			
Sensor switch type		Light in front (CS1-F), Light on top (CS1-U),Mini (CS1-S)			
Sensor switch holder		B-20	B-25	B-32	B-40
Additional variants		Stainless steel piston rod, female, extended, special thread piston rod			

ISO6430 Stainless Steel Slim Cylinder (MIA MIAD MIAJ MIAT Series)



Ordering Code

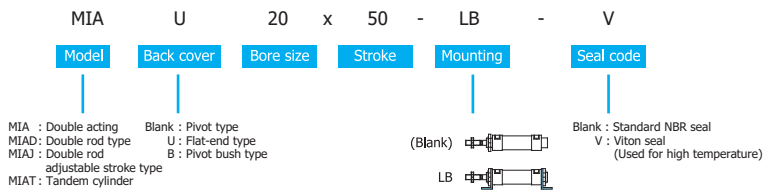

Symbol

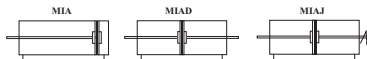

Specifications

Bore size	mm	20	25	32	40
Rod diameter	mm	8	10	12	16
Port size	inch	1/8	1/8	1/8	1/8
MIA standard stroke	mm	25~300	25~400	25~400	25~400
MIAD , MIAJ standard stroke	mm	25~200	25~250	25~250	25~250
MIA maximum stroke	mm	500	500	500	500
MIAD , MIAJ maximum stroke	mm	200	250	250	250
MIA available stroke up	mm	600	600	600	600
MIAD , MIAJ available stroke up	mm	300	300	300	300
MIAJ adjusting stroke	mm	25,50,75			
Action type		Double acting			
Media		Air			
Pressure range	kgf/cm ²	1.00~9.00			
Temperature range	°C	0 ~ 70 (Viton : 120)			
MIA speed range	mm/sec	50~800	50~800	50~800	50~800
MIAD , MIAJ speed range	mm/sec	30~800	30~800	30~800	30~800
MIA back cover type		Pivot (Blank) , Flat end (U) , Pivot bush (B)			
MIAD , MIAJ cushion type		Bumper			
MIAD , MIAJ adjust type		Variable			
MIA mounting type		Basic (Blank),Foot (LB),Flange(FA),Pivot (SDB)			
MIAD , MIAJ mounting type		Basic (Blank) , Foot (LB)			
End rod type		I knuckle (I), Y knuckle (Y), Floating joint(FJ),Universal joint(EJ)			
Sensor switch type		Light in front (CS1-F), Light on top (CS1-U), Mini (CS1-S)			
Sensor switch holder		B-20	B-25	B-32	B-40
Additional variants		Stainless steel piston rod, female, extended, special thread piston rod			

Other Available Series

Description	Ordering Code	Mounting type				
		LB	FA	SDB	Front mounting	Up mounting
<p>MIAD</p>	<p>MIAD - 20 x 50 - LB</p> <p>LB : Mounting type 50 : Stroke 20 : Bore size MIAD : Double rod type</p>	●	●	×	×	×
<p>MIAJ</p>	<p>MIAJ - 20 x 50 - 25 - LB</p> <p>LB : Mounting type 25 : 50 : Stroke 20 : Bore size MIAJ : Adjustable stroke type</p>	●	●	×	×	×

Dimensions

MISA

Pivot type

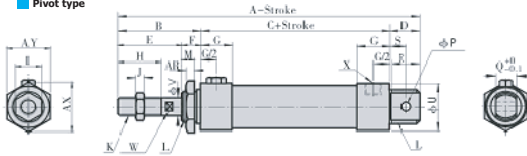

Flat-end type



Item Bore size	A		A2		B	C		D	E	F	G	H	I	J	K	L	M	P	Q	R	S	U	V	W	X	AR	AX	AY
	0-50	51-100	0-50	51-100		0-50	51-100																					
20	145	170	124	149	48	76	101	21	28	20	16	20	12	6	M8 x 1.25	M22 x 1.5	10	8	16	19	12	27	8	6	1/8"	7	33	29
25	149	174	128	153	52	76	101	21	30	22	16	22	17	6	M10 x 1.25	M22 x 1.5	12	8	16	19	12	30	10	8	1/8"	7	33	29
32	163	188	136	161	60	76	101	27	30	30	16	22	17	6	M10 x 1.25	M24 x 2.0	12	10	16	25	15	35	12	10	1/8"	8	37	32
40	170	195	143	168	67	76	101	27	32	35	16.7	24	17	7	M12 x 1.25	M30 x 2.0	12	12	20	25	15	41.6	16	14	1/8"	9	47	41

MITA

Pivot type

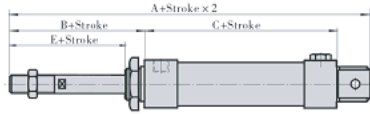

Flat-end type



Item Bore size	A				A2				C			
	0-25	26-50	51-75	76-100	0-25	26-50	51-75	76-100	0-25	26-50	51-75	76-100
20	160	170	185	195	139	149	164	174	91	101	116	126
25	164	174	189	199	143	153	168	178	91	101	116	126
32	178	188	208	208	151	161	181	181	91	101	121	121
40	185	195	215	225	158	168	188	188	91	101	121	131

Item Bore size	A				A2				C			
	0-25	26-50	51-75	76-100	0-25	26-50	51-75	76-100	0-25	26-50	51-75	76-100
20	170	170	180	180	149	149	159	159	101	101	111	111
25	174	174	184	184	153	153	163	163	101	101	111	111
32	188	188	198	198	161	161	171	171	101	101	111	111
40	195	195	205	205	168	168	178	178	101	101	111	111

MIA

Pivot type

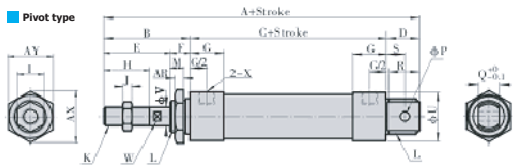

Flat-end type

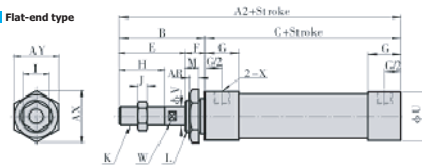

Item Bore size	A	A2	B	C	D	E	F	G	H	I	J	K	L	M	P	Q	R	S	U	V	W	X	AR	AX	AY
	20	145	124	48	76	21	28	20	16	20	12	6	M8 x 1.25	M22 x 1.5	10	8	16	19	12	27	8	6	1/8"	7	33
25	149	128	52	76	21	30	22	16	22	17	6	M10 x 1.25	M22 x 1.5	12	8	16	19	12	30	10	8	1/8"	7	33	29
32	163	136	60	76	27	30	30	16	22	17	6	M10 x 1.25	M24 x 2.0	12	10	16	25	15	35	12	10	1/8"	8	37	32
40	170	143	67	76	27	32	35	16.7	24	17	7	M12 x 1.25	M30 x 2.0	12	12	20	25	15	41.6	16	14	1/8"	9	47	41

MIAD

Pivot type

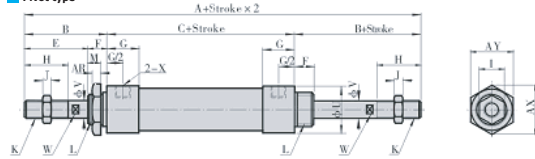

Item Bore size	A	B	C	E	F	G	H	I	J	K	L	M	U	V	W	X	AR	AX	AY
	20	172	48	76	28	20	16	20	12	6	M8 x 1.25	M22 x 1.5	10	27	8	6	1/8"	7	33
25	180	52	76	30	22	16	22	17	6	M10 x 1.25	M22 x 1.5	12	30	10	8	1/8"	7	33	29
32	196	60	76	30	30	16	22	17	6	M10 x 1.25	M24 x 2.0	12	35	12	10	1/8"	8	37	32
40	210	67	76	32	35	16.7	24	17	7	M12 x 1.25	M30 x 2.0	12	41.6	16	14	1/8"	9	47	41

MIAJ

Pivot type

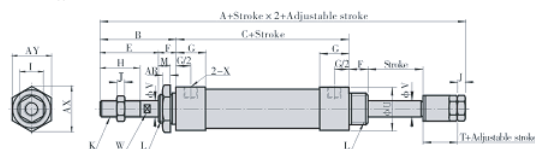

Item Bore size	A	B	C	E	F	G	H	I	J	K	L	M	T	U	V	W	X	AR	AX	AY
	20	169	48	76	28	20	16	20	12	6	M8 x 1.25	M22 x 1.5	10	19	27	8	6	1/8"	7	33
25	177	52	76	30	22	16	22	17	6	M10 x 1.25	M22 x 1.5	12	21	30	10	8	1/8"	7	33	29
32	193	60	76	30	30	16	22	17	6	M10 x 1.25	M24 x 2.0	12	21	35	12	10	1/8"	8	37	32
40	205	67	76	32	35	16.7	24	17	7	M12 x 1.25	M30 x 2.0	12	21	41.6	16	14	1/8"	9	47	41

FA

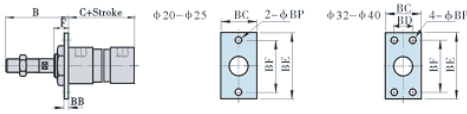

Item Bore size	B	C (M/A)	C (MISA)			BB	BC	BD	BE	BF	BP	F				
			0-50	51-100	101-150											
20	48	76	76	101	-	4	38	-	64	50	6.5	20				
25	52	76	76	101	-	4	38	-	64	50	6.5	22				
32	60	76	76	101	-	4	47	33	72	58	6.5	30				
40	67	76	76	101	-	4	50	36	84	70	6.5	35				

LB

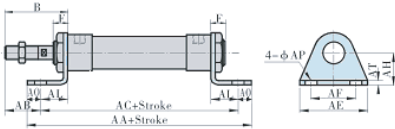

Item Bore size	B	F	AA (M/A)	AA (MISA)			AB	AC (M/A)	AC (MISA)			AE	AF	AL	AQ	AP	AT	AH
				0-50	51-100	101-150			0-50	51-100	101-150							
20	48	20	122	76	101	-	33	106	106	131	-	54	40	15	8	6.5	3	25
25	52	22	122	76	101	-	37	106	106	131	-	54	40	15	8	6.5	3	25
32	60	30	142	76	101	-	35	126	126	151	-	59	45	25	8	6.5	4	32
40	67	35	142	76	101	-	42	126	126	151	-	64	50	25	8	6.5	4.5	36

SDB

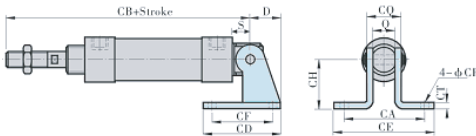

Item Bore size	D	S	Q	CA	CB (M/A)	CB (MISA)			CD	CE	CF	CH	CT	CP	CQ				
						0-50	51-100	101-150											
20	21	12	16	51	136	136	161	-	48	67	32	32	3	6.5	22				
25	21	12	16	51	140	140	165	-	48	67	32	32	3	6.5	22				
32	27	15	16	51	151	151	176	-	52	67	36	36	4	6.5	24				
40	27	15	20	55	158	158	183	-	56	71	40	40	4	6.5	28				

Y Knuckle

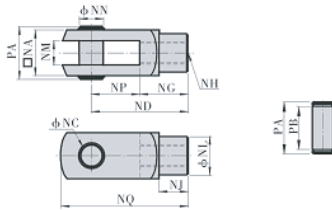

Item Bore size	NA	NC	ND	NE	NF	NG	NH	NJ	NK	NL	NM	NN	NP	NQ	PA	PB
25	19	10	40	52	15	20	M10 x 1.25	12	20	18	10	10	20	52	25	19.5
32	19	10	40	52	15	20	M10 x 1.25	12	20	18	10	10	20	52	25	19.5
40	25.4	10	45	57	15	25	M12 x 1.25	15	24	23	14	10	20	57	31	26

I Knuckle

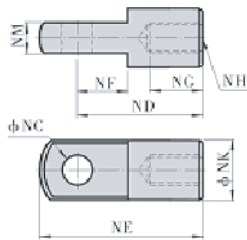

Item Bore size	NA	NC	ND	NE	NF	NG	NH	NJ	NK	NL	NM	NN	NP	NQ	PA	PB
25	19	10	40	52	15	20	M10 x 1.25	12	20	18	10	10	20	52	25	19.5
32	19	10	40	52	15	20	M10 x 1.25	12	20	18	10	10	20	52	25	19.5
40	25.4	10	45	57	15	25	M12 x 1.25	15	24	23	14	10	20	57	31	26

Floating Joint

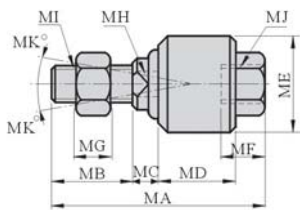

Item Bore size	MA	MB	MC	MD	ME	MF	MG	MH	MI	MJ	MK				
												20	51	20	6
25	58	22	7	21	26	11.5	7	10	M10 x 1.25	M10 x 1.25	12				
32	58	22	7	21	26	11.5	7	10	M10 x 1.25	M10 x 1.25	12				
40	58	22	8	21	28	11.5	8	12	M12 x 1.25	M12 x 1.25	12				

Universal (Fish eye) Joint

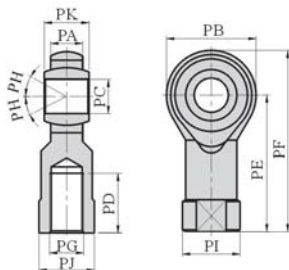

Item Bore size	PA	PB	PC	PD	PE	PF	PG	PH	PI	PJ	PK				
												20	9	24	8
25	11	26	10	20	43	56	M10 x 1.25	13	19	17	14				
32	11	26	10	20	43	56	M10 x 1.25	13	19	17	14				
40	12	32	12	24	50	66	M12 x 1.25	13	22	19	16				