

### Stainless Steel Slim Cylinder (AMSA AMTA Series)

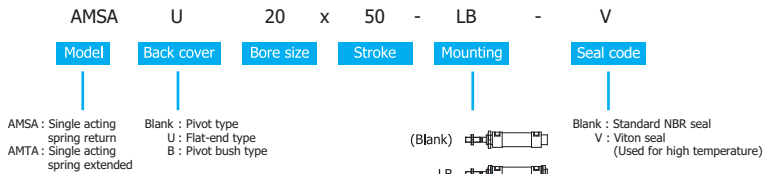

#### Ordering Code



#### Symbol

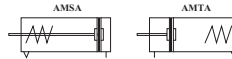

#### Specifications

Bore size	mm	16	20	25	32	40
Rod diameter	mm	6	8	10	12	16
Port size	inch	M5 X 0.8	1/8	1/8	1/8	1/8
Standard stroke	mm	25~75	25~100	25~100	25~100	25~100
Maximum stroke	mm	75	100	100	100	100
Available stroke up	mm	100	150	150	150	150
Action type	Single acting					
Media	Air					
Pressure range	kgf/cm <sup>2</sup>	2.00 ~ 9.00				
Temperature range	°C	0 ~ 70 (Viton : 120)				
Speed range	mm/sec	30 ~ 800				
Back cover type	Pivot (Blank) , Flat end (U) , Pivot bush (B)					
Cushion type	Bumper					
Mounting type	Basic (Blank),Foot (LB),Flange(FA),Pivot (SDB)					
End rod type	I knuckle (I), Y knuckle (Y), Floating joint(FJ),Universal joint(EJ)					
Sensor switch type	Light in front (CS1-F),Light on top(CS1-U),Mini (CS1-S)					
Sensor switch holder	B-16	B-20	B-25	B-32	B-40	
Additional variants	Stainless steel piston rod, female, extended, special thread piston rod					

### Stainless Steel Slim Cylinder (AMA AMAD AMAJ Series)



#### Ordering Code

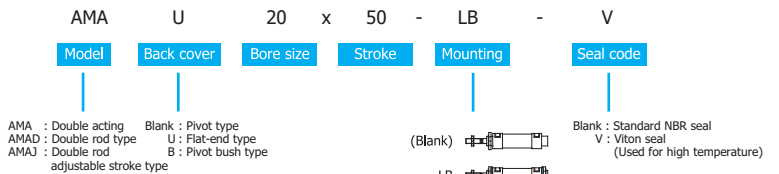

#### Symbol

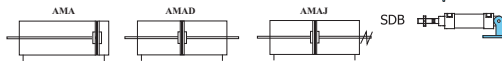

#### Specifications

Bore size	mm	16	20	25	32	40
Rod diameter	mm	6	8	10	12	16
Port size	inch	M5 X 0.8	1/8	1/8	1/8	1/8
AMA standard stroke	mm	25~200	25~300	25~400	25~400	25~400
AMAD , AMAJ standard stroke	mm	25~150	25~200	25~250	25~250	25~250
AMA maximum stroke	mm	300	500	500	500	500
AMAD , AMAJ maximum stroke	mm	150	200	250	250	250
AMA available stroke up	mm	500	1000	1000	1000	1000
AMAD , AMAJ available stroke up	mm	200	300	300	300	300
AMAJ adjusting stroke	mm	25,50,75				
Action type	Double acting					
Media	Air					
Pressure range	kgf/cm <sup>2</sup>	1.00~9.00				
Temperature range	°C	0 ~ 70 (Viton : 120)				
AMA speed range	mm/sec	50~800	50~800	50~800	50~800	50~800
AMAD , AMAJ speed range	mm/sec	30~800	30~800	30~800	30~800	30~800
AMA back cover type	Pivot (Blank) , Flat end (U) , Pivot bush (B)					
AMA,AMAD,AMAJ cushion type	Bumper					
AMAD , AMAJ adjust type	Variable					
AMA mounting type	Basic (Blank),Foot (LB),Flange(FA),Pivot (SDB)					
AMAD , AMAJ mounting type	Basic (Blank) , Foot (LB)					
End rod type	I knuckle (I), Y knuckle (Y), Floating joint(FJ),Universal joint(EJ)					
Sensor switch type	Light in front (CS1-F),Light on top(CS1-U), Mini (CS1-S)					
Sensor switch holder	B-16	B-20	B-25	B-32	B-40	
Additional variants	Stainless steel piston rod, female, extended, special thread piston rod					

#### Other Available Series

Description	Ordering Code	Mounting type				
		LB	FA	SDB	Front mounting	Up mounting
<p>AMAD</p>	AMAD - 20 x 50 - LB LB : Mounting type 50 : Stroke 20 : Bore size AMAD : Double rod type	●	●	×	×	×
<p>AMAJ</p>	AMAJ - 20 x 50 - 25 - LB LB : Mounting type 25 : 50 : Stroke 20 : Bore size AMAJ : Adjustable stroke type	●	●	×	×	×

## Pneumatic Equipment

### Dimensions

#### AMSA

**Pivot type**

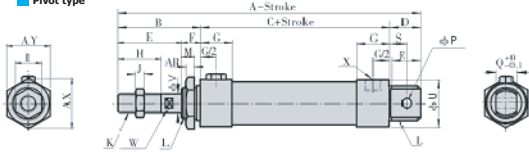

**Flat-end type**



Item	A		A1		B	C				D	E	F	G	H	I	J	K	L	M	P	Q	R	S	U	V	W	X	AR	AX	AY
Bore size	0~50	51~100	0~50	51~100		0~50	51~100																							
16	114	139	98	123	38	60	85	16	22	16	10	16	10	16	10	5	M6 x 1	M16 x 1.5	14	6	12	14	9	21	6	5	M5	6	25	22
20	137	162	116	141	40	76	101	21	28	12	16	20	12	6	6	M8 x 1.25	M22 x 1.5	10	8	16	19	12	27	8	6	1/8"	7	33	29	
25	141	166	120	145	44	76	101	21	30	14	16	22	17	6	6	M10 x 1.25	M22 x 1.5	12	8	16	19	12	30	10	8	1/8"	7	33	29	
32	147	172	120	145	44	76	101	27	30	14	16	22	17	6	6	M10 x 1.25	M24 x 2.0	12	10	16	25	15	35	12	10	1/8"	8	37	32	
40	149	174	122	147	46	76	101	27	32	14	16.7	24	17	7	7	M12 x 1.25	M30 x 2.0	12	12	20	25	15	41.6	16	14	1/4"	9	47	41	

#### AMTA

**Pivot type**

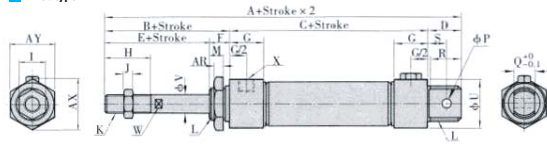

**Flat-end type**

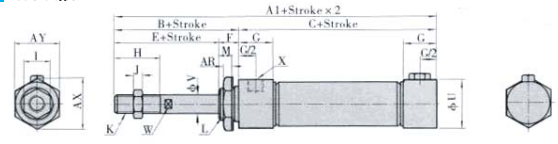

Item	A				A1				B	C				D	E	F	G	H	I	J	K	L	M	P	Q	R	S	U	V	W	X	AR	AX	AY
Bore size	0~25	26~50	51~75	76~100	0~25	26~50	51~75	76~100		0~25	26~50	51~75	76~100																					
16	129	139	154	164	113	123	138	148	38	75	85	100	110	16	22	16	10	16	10	5	M6 x 1	M16 x 1.5	14	6	12	14	9	21	6	5	M5	6	25	22
20	152	162	177	187	131	141	156	166	40	91	101	116	126	21	28	12	16	20	12	6	M8 x 1.25	M22 x 1.5	10	8	16	19	12	27	8	6	1/8"	7	33	29
25	156	166	181	191	135	145	160	170	44	91	101	116	126	21	30	14	16	22	17	6	M10 x 1.25	M22 x 1.5	12	8	16	19	12	30	10	8	1/8"	7	33	29
32	162	172	192	192	135	145	165	165	44	91	101	121	121	27	30	14	16	22	17	6	M10 x 1.25	M24 x 2.0	12	10	16	25	15	35	12	10	1/8"	8	37	32
40	164	174	194	204	137	147	167	177	46	91	101	121	131	27	32	14	16.7	24	17	7	M12 x 1.25	M30 x 2.0	12	12	20	25	15	41.6	16	14	1/8"	9	47	41

#### AMA

**Pivot type**

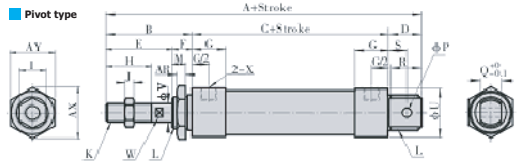

**Flat-end type**

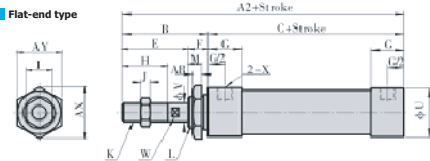

Item	A	A1	B	C	D	E	F	G	H	I	J	K	L	M	P	Q	R	S	U	V	W	X	AR	AX	AY
Bore size																									
16	114	98	38	60	16	22	16	10	16	10	5	M6 x 1	M16 x 1.5	14	6	12	14	9	21	6	5	M5	6	25	22
20	137	116	40	76	21	28	12	16	20	12	6	M8 x 1.25	M22 x 1.5	10	8	16	19	12	27	8	6	1/8"	7	33	29
25	141	120	44	76	21	30	14	16	22	17	6	M10 x 1.25	M22 x 1.5	12	8	16	19	12	30	10	8	1/8"	7	33	29
32	147	120	44	76	27	30	14	16	22	17	6	M10 x 1.25	M24 x 2.0	12	10	16	25	15	35	12	10	1/8"	8	37	32
40	149	122	46	76	27	32	14	16.7	24	17	7	M12 x 1.25	M30 x 2.0	12	12	20	25	15	41.6	16	14	1/4"	9	47	41

#### AMAD

**Pivot type**

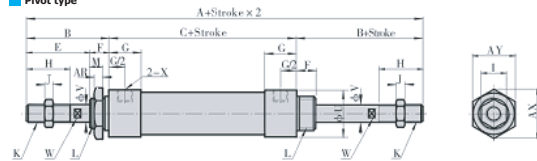

Item	A	B	C	E	F	G	H	I	J	K	L	M	U	V	W	X	AR	AX	AY
Bore size																			
16	136	38	60	22	16	10	16	10	5	M6 x 1	M16 x 1.5	14	21	6	5	M5	6	25	22
20	156	40	76	28	12	16	20	12	6	M8 x 1.25	M22 x 1.5	10	27	8	6	1/8"	7	33	29
25	164	44	76	30	14	16	22	17	6	M10 x 1.25	M22 x 1.5	12	30	10	8	1/8"	7	33	29
32	164	44	76	30	14	16	22	17	6	M10 x 1.25	M24 x 2.0	12	35	12	10	1/8"	8	37	32
40	168	46	76	32	14	16.7	24	17	7	M12 x 1.25	M30 x 2.0	12	41.6	16	14	1/8"	9	47	41
50	199	52	95	32	20	23	24	19	8	M14 x 1.5	M36 x 2.0	14.5	53	16	14	1/4"	11	53	46
63	199	52	95	32	20	23	24	19	8	M14 x 1.5	M36 x 2.0	14.5	67	16	14	1/4"	11	53	46

#### AMAJ

**Pivot type**

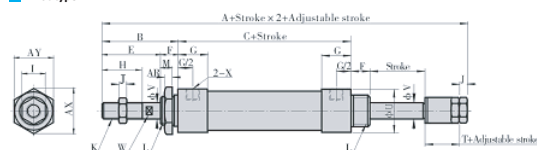

Item	A	B	C	E	F	G	H	I	J	K	L	M	T	U	V	W	X	AR	AX	AY
Bore size																				
16	136	38	60	22	16	10	16	10	5	M6 x 1	M16 x 1.5	14	17	21	6	5	M5	6	25	22
20	153	40	76	28	12	16	20	12	6	M8 x 1.25	M22 x 1.5	10	19	27	8	6	1/8"	7	33	29
25	161	44	76	30	14	16	22	17	6	M10 x 1.25	M22 x 1.5	12	21	30	10	8	1/8"	7	33	29
32	161	44	76	30	14	16	22	17	6	M10 x 1.25	M24 x 2.0	12	21	35	12	10	1/8"	8	37	32
40	164	46	76	32	14	16.7	24	17	7	M12 x 1.25	M30 x 2.0	12	21	41.6	16	14	1/4"	9	47	41

FA

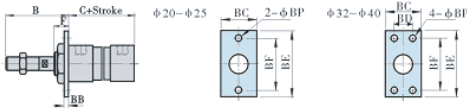

Item Bore size	B	C (MA)	C (MSA)		BB	BC	BD	BE	BF	BP	F				
			0~50	51~100											
16	38	60	60	85	3.2	26	-	52	40	5.5	16				
20	40	76	76	101	4	38	-	64	50	6.5	12				
25	44	76	76	101	4	38	-	64	50	6.5	14				
32	44	76	76	101	4	47	33	72	58	6.5	14				
40	46	76	76	101	4	50	36	84	70	6.5	14				

LB

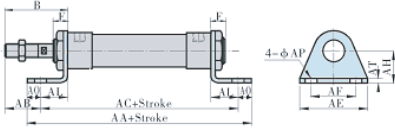

Item Bore size	B	F	AA (MA)	AA (MSA)		AB	AC (MA)	AC (MSA)		AE	AF	AL	AQ	AP	AT	AH
				0~50	51~100			0~50	51~100							
16	38	12	98	98	123	25	86	86	111	44	32	13	6	5.5	3.2	20
20	40	12	122	122	147	25	106	106	131	54	40	15	8	6.5	3.2	25
25	44	14	122	122	147	29	106	106	131	54	40	15	8	6.5	3.2	25
32	44	14	142	142	167	19	126	126	151	59	45	25	8	6.5	4	32
40	46	14	142	142	167	21	126	126	151	64	50	25	8	6.5	4.5	36

SDB

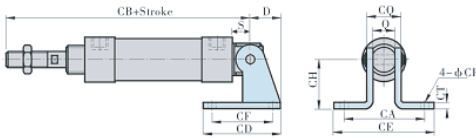

Item Bore size	D	S	Q	CA	CB (MA)	CB (MSA)		CD	CE	CF	CH	CT	CP	CQ
						0~50	51~100							
16	16	9	12	-	107	107	132	23	-	12	20	2.3	5.5	16.5
20	21	12	16	51	128	128	153	48	67	32	32	3	6.5	22
25	21	12	16	51	132	132	157	48	67	32	32	3	6.5	22
32	27	15	16	51	135	135	160	52	67	36	36	4	6.5	24
40	27	15	20	55	137	137	162	56	71	40	40	4	6.5	28

Y Knuckle

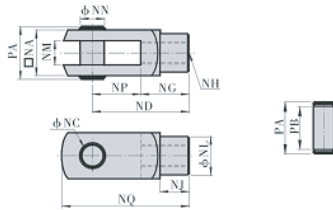

Item Bore size	NA	NC	ND	NE	NF	NG	NH	NJ	NK	NL	NM	NN	NP	NQ	PA	PB
25	19	10	40	52	15	20	M10 x 1.25	12	20	18	10	10	20	52	25	19.5
32	19	10	40	52	15	20	M10 x 1.25	12	20	18	10	10	20	52	25	19.5
40	25.4	10	45	57	15	25	M12 x 1.25	15	24	23	14	10	20	57	31	26

I Knuckle

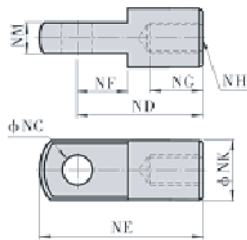

Item Bore size	NA	NC	ND	NE	NF	NG	NH	NJ	NK	NL	NM	NN	NP	NQ	PA	PB
25	19	10	40	52	15	20	M10 x 1.25	12	20	18	10	10	20	52	25	19.5
32	19	10	40	52	15	20	M10 x 1.25	12	20	18	10	10	20	52	25	19.5
40	25.4	10	45	57	15	25	M12 x 1.25	15	24	23	14	10	20	57	31	26

Floating Joint

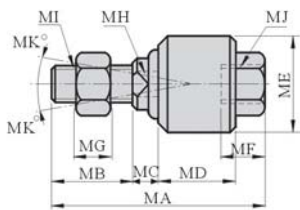

Item Bore size	MA	MB	MC	MD	ME	MF	MG	MH	MI	MJ	MK				
												20	51	20	6
25	58	22	7	21	26	11.5	7	10	M10 x 1.25	M10 x 1.25	12				
32	58	22	7	21	26	11.5	7	10	M10 x 1.25	M10 x 1.25	12				
40	58	22	8	21	28	11.5	8	12	M12 x 1.25	M12 x 1.25	12				

Universal (Fish eye) Joint

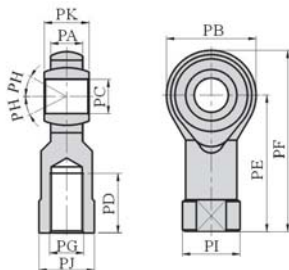

Item Bore size	PA	PB	PC	PD	PE	PF	PG	PH	PI	PJ	PK				
												20	9	24	8
25	11	26	10	20	43	56	M10 x 1.25	13	19	17	14				
32	11	26	10	20	43	56	M10 x 1.25	13	19	17	14				
40	12	32	12	24	50	66	M12 x 1.25	13	22	19	16				